

Creating and Adding Subassemblies

Goals:

1. Create a subassembly that functions within a larger assembly.
2. Practice applying various mate types.
3. Determine how a subassembly should be mated into the main assembly.



Creating and Adding Subassemblies

Instructions:

1. Open the Onshape document "[Exercise 8 - Creating and Adding Subassemblies](#)".
2. Create a new assembly named "Lens Tube Subassembly".
3. Insert the following parts into the assembly:
 - The entire Lens Tube part studio
 - The part "Lens Mount" from the Reflector part studio

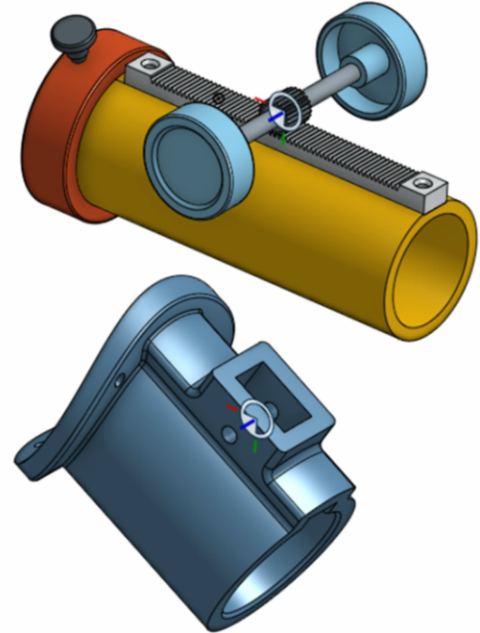

Creating and Adding Subassemblies

Instructions:(continued)

4. Add a Group mate for the following parts:
 - Axle Gear
 - Turn Handle (2)
5. Add a Group mate for the following parts:
 - Bezel
 - Lens Tube
 - Rack
 - Thumb Wheel Fastener (2)
6. Add a Revolute mate to the mate connectors for the Axle Gear and the Lens Mount.

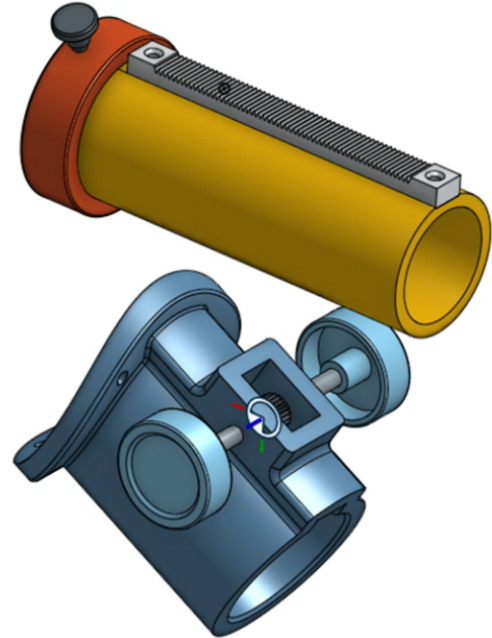

Creating and Adding Subassemblies

Instructions:(continued)

7. Add a Slider mate between the Rack and the Lens Mount.

(Hint: Cylindrical surfaces can be used to select the correct mate connectors.)

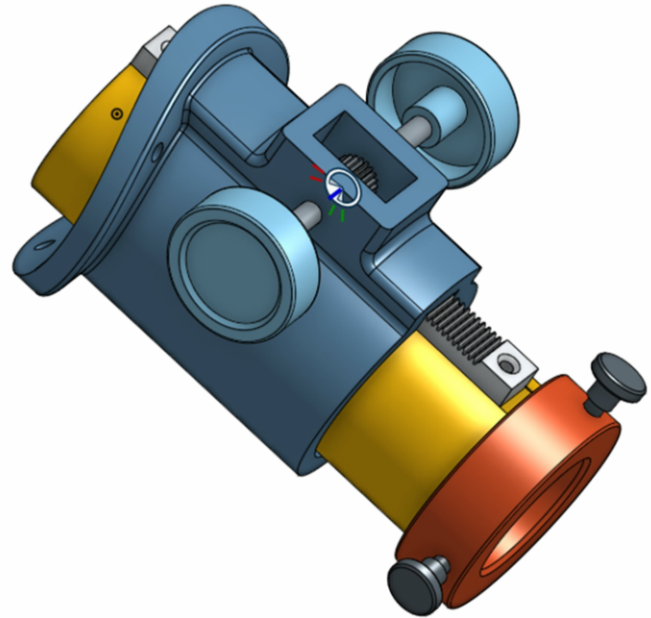

Creating and Adding Subassemblies

Instructions:(continued)

- Optional Bonus! Add a Rack and Pinion mate between the Rack and the Axle Gear. Set the "distance per revolution" to 1.

(Hint: This mate type requires two specific mate types to be selected.)

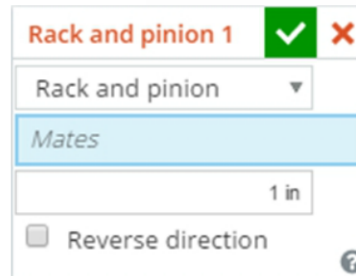
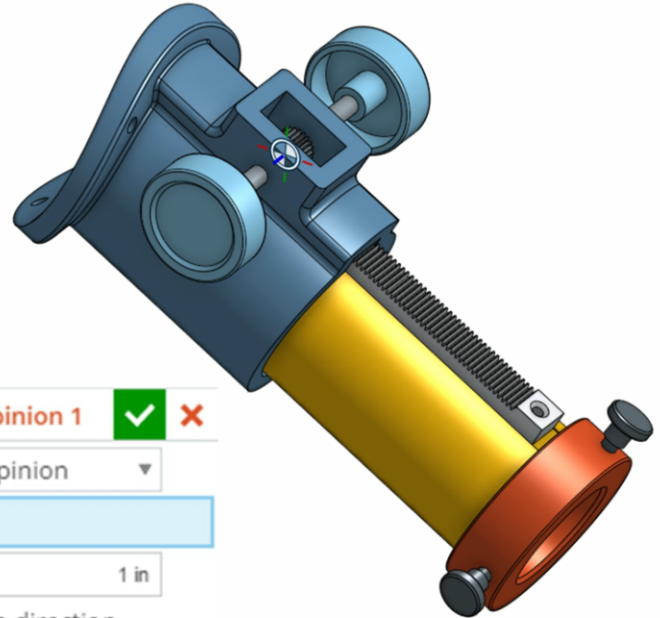

Creating and Adding Subassemblies

Instructions:(continued)

9. Open the assembly "Reflector".
10. Insert the Lens Tube subassembly into the Reflector assembly.
11. Use a Fastened mate to attach the Lens Mount to the Main Tube.

(Hint: Selecting a corner on the Lens Mount and an exterior corner on the Main Tube will allow for the correct mate relation. The mate orientation may need to be adjusted.)

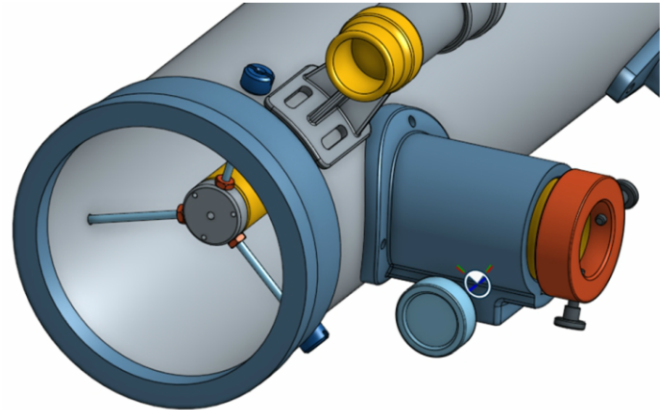

Creating and Adding Subassemblies

Instructions:(continued)

12. Switch over to the tab "Main Assembly".
13. Insert the following into the assembly:
 - The "Reflector" subassembly
 - The "Height Adjuster" subassembly
 - The "Mount" part studio
14. Add a Revolute mate between the top of the tripod and the Mount.

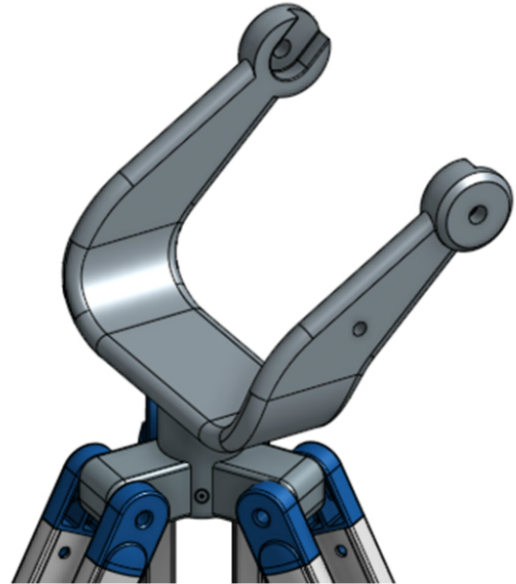

Creating and Adding Subassemblies

Instructions:(continued)

15. Add a Revolute mate between the Mount and the Pivot Mount of the Reflector subassembly.

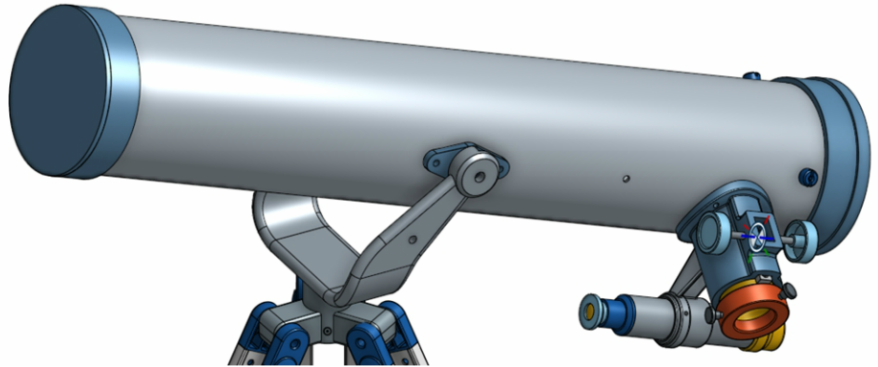

Creating and Adding Subassemblies

Instructions:(continued)

16. Add a Revolute mate between the Mount and the Guide of the Height Adjuster subassembly.
17. Add a Revolute mate between the Main Tube of the Reflector subassembly and the Mount Boss of the Height Adjuster subassembly.

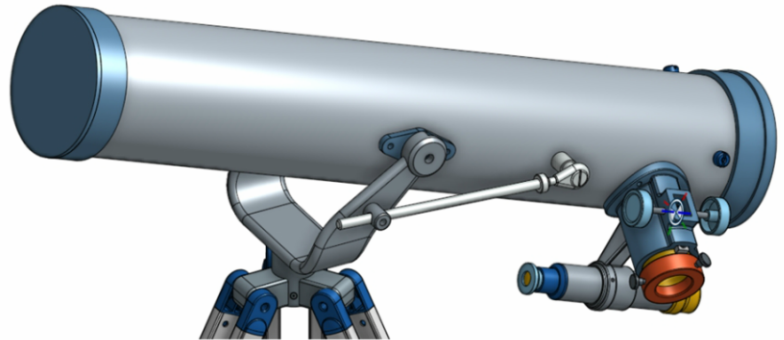

Creating and Adding Subassemblies

Assessment:

How many of each of the following mate types were used in this exercise?

Fastened -

Revolute -

Slider -

Group -

Rack and Pinion -

